

Installing a Lily Pad

Models MPP-PAD-1 and MPP-PAD-2



INSTRUCTION SHEET

Use the following information to install a Lily Pad support platform onto a Pickup Pod. The Lily Pad is an accessory that provides an extended support platform for the Pickup Pod when anchoring to a wall is not possible (for example, when the Pickup Pod is positioned against a glass wall). The installation procedure for both styles of Lily Pads is the same.

Tools Needed

- Socket Wrench
- 9/16" Socket



Use extreme caution when moving and tipping unit during installation. Size and weight of unit create significant tip and pinch point hazards. Remain aware and keep clear of unit/pinch points while tipping to avoid serious injury.

Do not lay unit on its front side. Damage to doors could occur.

NOTE: Due to the size and weight of the Pickup Pod, use the proper number of people for installation.

NOTE: Place a piece of cardboard between the Pickup Pod and the work surface to prevent marring the Pod finish.

1. If the Pickup Pod is not already in the horizontal position, carefully lay the Pod on its back with the doors facing up. **WARNING! This step will require several people.**
2. Remove the base gasket and four (4) leveling feet from the bottom of the Pickup Pod.

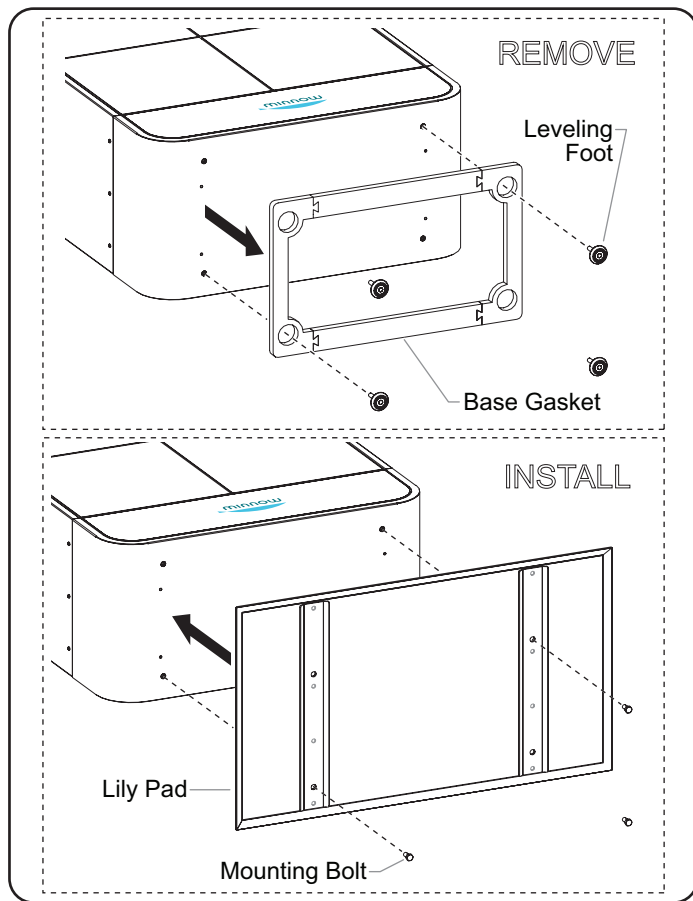

3. Install the Lily Pad.
 - a. Locate a block of wood or something similar to raise the bottom of the Pickup Pod during Lily Pad installation.
 - b. Align the mounting holes on the Lily Pad with the leveling feet holes on the Pickup Pod. Make sure the pad is oriented so that it extends beyond the front of the unit, not the back.
 - c. Insert the four (4) mounting bolts through the bottom of the Lily Pad and into the Pickup Pod. Using a socket wrench and a 9/16" socket, tighten the bolts securely.
4. With the help of several people, carefully tip up the Pickup Pod to its vertical position.
5. Being careful not to damage the floor, move the Pickup Pod to its final location. Refer to the *Installation and Operation Manual* for installation location requirements.
 - For additional stability, adjust the wall anchoring bracket on the Pickup Pod so that it is flush against the wall above the unit.

